

# LDK® Pillow Blocks

UCAK Standard duty, Wider inner ring bearing, Low center height housing, Setscrew locking

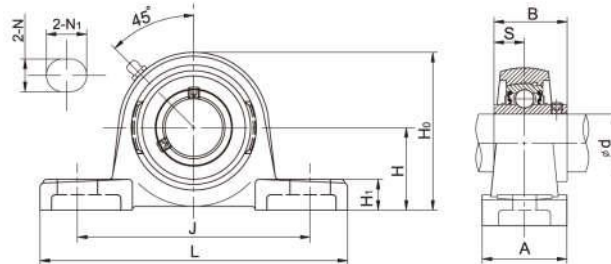

Unit No.	Shaft Dia		Dimensions (mm)										Bolt Size (mm)	Weight (kg)	
	d (in)	d (mm)	H	L	J	A	N	N <sub>1</sub>	H <sub>1</sub>	H <sub>0</sub>	B	S			
UCAK201		12													
201-8	1/2	12													
UCAK202		15	27	121	89	35	12	16	13	54	26	10	M10	0.74	
202-10	5/8	15													
UCAK203		17													
UCAK204		20	31.8	133	98	41	12	16	14.3	64	31	12.7	M10	0.77	
204-12	3/4	20													
UCAK205		25													
205-13	13/16	25													
205-14	7/8	25	33.3	140	105	45	12	16	16	68	34	14.3	M10	0.91	
205-15	15/16	25													
205-16	1	25													
UCAK206		30													
206-17	1-1/16	30													
206-18	1-1/8	30	39.7	160	121	48	15	19	17	80	38.1	15.9	M12	1.27	
206-19	1-3/16	30													
206-20	1-1/4	30													
UCAK207		35													
207-20	1-1/4	35													
207-21	1-5/16	35	46	167	127	48	15	19	19	92	42.9	17.5	M12	1.59	
207-22	1-3/8	35													
207-23	1-7/16	35													
UCAK208		40													
208-24	1-1/2	40	49.2	181	140	54	15	19	19	100	49.2	19	M12	2.06	
208-25	1-9/16	40													
UCAK209		45													
209-26	1-5/8	45	52.4	190	146	54	15	19	21	106	49.2	19	M12	2.33	
209-27	1-11/16	45													
209-28	1-3/4	45													
UCAK210		50													
210-29	1-13/16	50	55.6	203	159	57	15	19	22	113	51.6	19	M12	2.68	
210-30	1-7/8	50													
210-31	1-15/16	50													
210-32	2	50													
UCAK211		55													
211-32	2	55	61.9	232	181	60	20	24	25	125	55.6	22.2	M16	3.62	
211-33	2-1/16	55													
211-34	2-1/8	55													
211-35	2-3/16	55													
UCAK212		60													
212-36	2-1/4	60	68.3	241	190	64	20	24	29	138	65.1	25.4	M16	4.61	
212-37	2-5/16	60													
212-38	2-3/8	60													
212-39	2-7/16	60													
UCAK213		65													
213-40	2-1/2	65	68.3	248	194	70	22	29	27	141	65.1	25.4	M20	6.42	
213-41	2-9/16	65													
UCAK214		70													
214-42	2-5/8	70	82.6	294	232	72	22	32	29	160	74.6	30.2	M20	7.18	
214-43	2-11/16	70													
214-44	2-3/4	70													
UCAK215		75													
215-45	2-13/16	75	84.1	304	241	74	22	32	32	165	77.8	33.3	M20	8.86	
215-46	2-7/8	75													
215-47	2-15/16	75													
215-48	3	75													

Notes: 1. Grease fittings available at 90° positions.  
2. Bearing housing solid base optional, add suffix SB as designation.