

# LDK<sup>®</sup> Pillow Blocks

UCP300 Heavy duty, Wider inner ring bearing, Setscrew locking

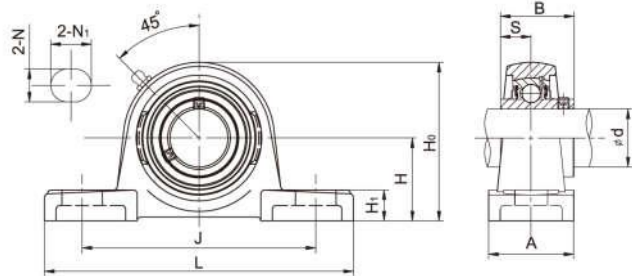

Unit No	Shaft d (mm)	Dimensions(mm)										Bolt size (mm)	Weight (kg)
		H	L	J	A	N	N <sub>1</sub>	H <sub>1</sub>	H <sub>0</sub>	B	S		
UCP305	25	45	175	132	45	17	20	16	85	38	15	M14	1.40
UCP306	30	50	180	140	50	17	20	18	95	43	17	M14	1.80
UCP307	35	56	210	160	56	17	25	20	106	48	19	M14	2.80
UCP308	40	60	220	170	60	17	25	24	116	52	19	M14	3.08
UCP309	45	67	245	190	67	20	30	25	129	57	22	M16	4.10
UCP310	50	75	275	212	75	20	35	27	143	61	22	M16	6.00
UCP311	55	80	310	236	80	20	38	30	154	66	25	M16	7.40
UCP312	60	85	330	250	85	25	38	32	165	71	26	M20	9.40
UCP313	65	90	335	260	90	25	38	33	176	75	30	M20	10.00
UCP314	70	95	360	280	90	27	40	35	187	78	33	M22	12.00
UCP315	75	100	380	290	100	27	40	35	198	82	32	M22	14.00
UCP316	80	106	400	300	110	27	40	40	210	86	34	M22	18.00
UCP317	85	112	420	320	110	33	45	40	220	96	40	M27	20.00
UCP318	90	118	430	330	110	33	45	45	235	96	40	M27	24.00
UCP319	95	125	470	360	120	36	50	46	250	103	41	M30	26.50
UCP320	100	140	490	380	120	36	50	50	275	108	42	M30	34.30
UCP321	105	140	490	380	120	36	50	50	280	112	44	M30	36.60
UCP322	110	150	520	400	140	40	55	55	300	117	46	M33	42.50
UCP324	120	160	570	450	140	40	55	65	320	126	51	M33	53.50
UCP326	130	180	600	480	140	40	55	75	355	135	54	M33	72.10
UCP328	140	200	620	500	140	40	55	75	390	145	59	M33	89.10

Notes: 1. Grease fittings available at 90° positions.  
2. Bearing housing solid base optional, add suffix SB as designation.