

Flange Cartridge Units **LDK**[®]

UKFC+H Standard duty, Tapered bore, Adapter sleeve locking

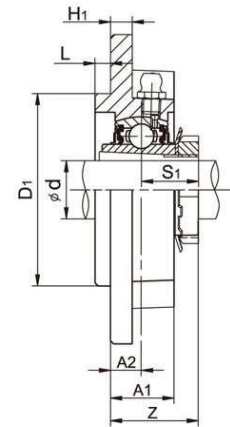
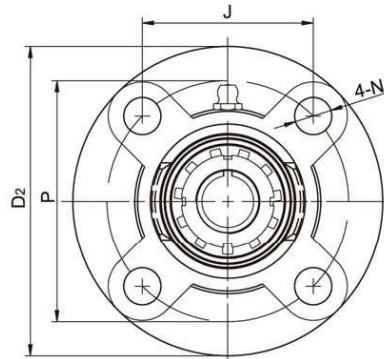

Unit No.	Shaft Dia		Dimensions (mm)											Bolt Size (mm)	Weight (kg)
	d (in)	d (mm)	D2	P	J	A2	N	L	H1	A1	D1	S1	Z		
UKFC205+H2305 205+HE2305	3/4	20	115	90	63.6	10	12	6	7	21	70	18.5	28.5	M10	0.98
UKFC206+H2306 206+HS2306 206+HA2306 206+HE2306	7/8 15/16 1	25	125	100	70.7	10	12	8	8	23	80	20.5	30.5	M10	1.2
UKFC207+H2307 207+HS2307 207+HA2307	1-1/8 1-3/16	30	135	110	77.8	11	14	8	9	26	90	22.5	33.5	M12	1.7
UKFC208+H2308 208+HE2308 208+HS2308	1-1/4 1-3/8	35	145	120	84.8	11	14	10	9	26	100	24.5	35.5	M12	2.0
UKFC209+H2309 209+HA2309 209+HE2309	1-7/16 1-1/2	40	160	132	93.3	10	16	12	10	26	105	26	36	M14	2.7
UKFC210+H2310 210+HS2310 210+HA2310 210+HE2310	1-5/8 1-11/16 1-3/4	45	165	138	97.6	10	16	12	14	28	110	27.5	37.5	M14	3.0
UKFC211+H2311 211+HS2311 211+HA2311 211+HE2311	1-7/8 1-15/16 2	50	185	150	106.1	13	19	12	15	30	125	28.5	41.5	M16	4.2
UKFC212+H2312 212+HS2312	2-1/8	55	195	160	113.1	17	19	12	15	35	135	31	48	M16	4.9
UKFC213+H2313 213+HA2313 213+HE2313 213+HS2313	2-3/16 2-1/4 2-3/8	60	205	170	120.2	16	19	14	15	36	145	32	48	M16	5.6
UKFC215+H2315 215+HA2315 215+HE2315	2-7/16 2-1/2	65	220	184	130.1	18	19	16	17	39	160	35.5	53.5	M16	7.5
UKFC216+H2316 216+HA2316 216+HE2316	2-11/16 2-3/4	70	240	200	141.4	18	23	16	18	42	170	39	57	M20	8.9
UKFC217+H2317 217+HA2317 217+HE2317	2-15/16 3	75	250	208	147.1	18	23	18	20	45	180	40	58	M20	10.4
UKFC218+H2318		80	265	220	155.5	22	23	18	20	50	190	42	64	M20	13.3