

Flange Cartridge Units **LDK**[®]

UCFCS Standard duty, Wider inner ring bearing, Inch-based housing, Setscrew locking

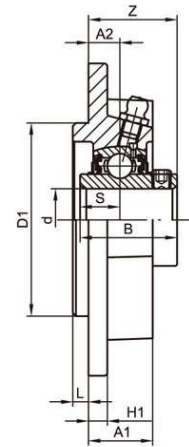
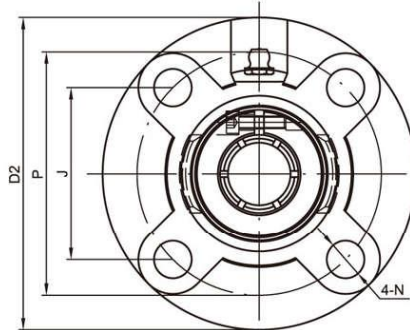

Unit No.	Shaft Dia		Dimensions (mm)											Weight (kg)	
	d		D2	P	J	A2	N	L	H1	A1	D1	S	B		Z
	(in)	(mm)													
UCFCS206		30													
206-17	1-1/16		111	92.08	65.11	9.9	12	6.1	9.4	23.9	76.2	15.9	38.1	32.1	1.26
206-18	1-1/8														
206-19	1-3/16														
206-20	1-1/4														
UCFCS207		35													
207-20	1-1/4														
207-21	1-5/16		127	104.78	74.09	7.9	12	9.4	9.4	22.6	85.725	17.5	42.9	33.3	1.84
207-22	1-3/8														
207-23	1-7/16														
UCFCS208		40													
208-24	1-1/2		133.1	111.1	78.56	8.9	12	10.9	10.9	25.9	92.075	19	49.2	39.1	2.02
208-25	1-9/16														
UCFCS209		45													
209-26	1-5/8		155.5	130.18	92.05	7.9	14	10.9	10.9	25.4	107.95	19	49.2	38.1	2.78
209-27	1-11/16														
209-28	1-3/4														
UCFCS210		50													
210-30	1-7/8		155.5	130.18	92.05	7.9	14	11.9	10.9	24.9	107.95	19	51.6	40.5	2.76
210-31	1-15/16														
210-32	2														
UCFCS211		55													
211-32	2		162	136.5	96.52	7.1	14	16.0	10.9	25.9	114.3	22.2	55.6	40.5	3.29
211-34	2-1/8														
211-35	2-3/16														
UCFCS212		60													
212-36	2-1/4		180.8	152.4	107.76	4	14	22.1	13	25.9	127	25.4	65.1	43.7	4.61
212-37	2-5/16														
212-38	2-3/8														
212-39	2-7/16														
UCFCS213		65													
213-39	2-7/16		193.8	165.1	116.74	10.9	14	20.0	14	33	139.7	25.4	65.1	50.6	5.91
213-40	2-1/2														
UCFCS214		70													
214-43	2-11/16		193.7	165.1	116.74	10.9	14	20.0	14	33.3	139.7	30.2	74.6	55.3	7.98
214-44	2-3/4														
UCFCS215		75													
215-47	2-15/16		222.2	190.5	134.7	14	17.5	20.0	16	36	161.925	33.3	77.8	58.5	8.34
215-48	3														