

# LDK<sup>®</sup> Bearing Inserts

## UCX/UCX..L3 Medium duty, Wider inner ring, Setscrew locking

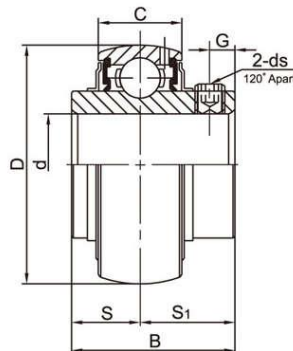

UCX00( Medium Duty)  
Spherical O.D.

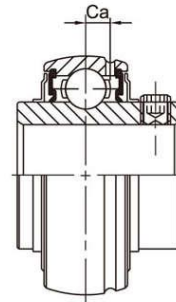

UCX00G  
Relubricatable type



SL TYPE SEAL



TJ TYPE SEAL



L3 TYPE SEAL

Bearing No.	Shaft Dia		Dimensions (mm)								Basic dynamic Load ratings (KN)	Basic static Load ratings (KN)	Weight (kg)	
	d		D	B	C	S	S <sub>1</sub>	G	ds					Ca
	(in)	(mm)							(mm)	(in.UNF)				
UCX 05		25												
05-13	13/16								M6X1					
05-14	7/8		62	38.1	19	15.9	22.2	5.5		1/4-28	5.3	19.47	11.43	0.39
05-15	15/16													
05-16	1													
UCX 06		30												
06-17	1-1/16								M8X1					
06-18	1-1/8		72	42.9	20	17.5	25.4	6.9		5/16-24	5.8	25.69	15.55	0.68
06-19	1-3/16													
06-20	1-1/4													
UCX 07		35												
07-21	1-5/16								M8X1					
07-22	1-3/8		80	49.2	21	19	30.2	8		5/16-24	6.2	29.51	18.14	0.82
07-23	1-7/16													
UCX 08		40												
08-24	1-1/2								M8X1					
08-25	1-9/16		85	49.2	22	19	30.2	8		5/16-24	6.5	31.85	20.80	0.93
UCX 09		45												
09-26	1-5/8								M10X1.25					
09-27	1-11/16		90	51.6	24	19	32.6	10		3/8-24	7	34.99	23.70	1.00
09-28	1-3/4													
UCX10		50												
10-30	1-7/8								M10X1.25					
10-31	1-15/16		100	55.6	25	22.2	33.4	10		3/8-24	7.4	43.34	29.39	1.35
UCX11		55												
11-33	2-1/16								M10X1.25					
11-34	2-1/8		110	65.1	27	25.4	39.7	10		3/8-24	7.6	47.68	33.43	1.90
11-35	2-3/16													
11-36	2-1/4													
UCX12		60												
12-38	2-3/8								M10X1.25					
12-39	2-7/16		120	65.1	28	25.4	39.7	10		3/8-24	8.5	57.20	40.01	2.27
UCX13		65												
13-40	2-1/2								M12X1.25					
13-41	2-9/16		125	74.6	29	30.2	44.4	12		7/16-20	8.9	62.19	43.90	2.45
UCX14		70												
14-42	2-5/8								M12X1.25					
14-43	2-11/16		130	77.8	30	33.3	44.5	12		7/16-20	9.2	62.08	44.82	2.47
14-44	2-3/4													
UCX15		75												
15-45	2-13/16								M12X1.25					
15-46	2-7/8		140	82.6	33	33.3	49.3	12		7/16-20	9.5	72.62	53.34	3.11
15-47	2-15/16													
15-48	3													
UCX16		80												
16-49	3-1/16								M12X1.25					
16-50	3-1/8		150	85.7	35	34.1	51.6	12		7/16-20	11.1	83.15	64.54	3.79
16-51	3-3/16													
UCX17		85												
17-53	3-5/16								M12X1.25					
17-55	3-7/16		160	96	37	39.7	56.3	12		1/2-20	11.8	95.84	72.64	4.82