

All Stainless Steel Bearing Units **LDK**[®]

SSUCFL..EHB/ESB All stainless steel flange units 2-bolt,Hollow/Solid base,Setscrew locking

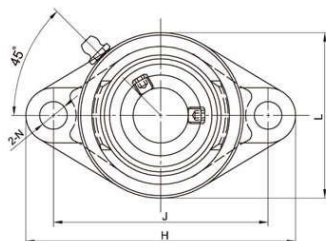

• SSUCFL200EHB (Hollow Base)

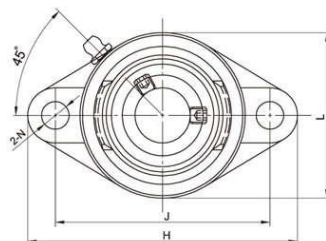

• SSUCFL200ESB (Solid Base)

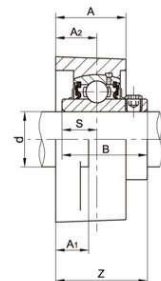

Unit No.		Shaft Dia		Dimensions(mm)										Bolt Size (mm)	Weight (kg)
Hollow Base Housing	Solid Base Housing	d		H	J	A ₂	A ₁	A	N	L	Z	B	S		
		(in)	(mm)												
SSUCFL204EHB 204-12EHB	SSUCFL204ESB 204-12ESB	3/4	20	113	90	15	11.5	27	10.5	60	33.3	31	12.7	M8	0.50
SSUCFL205EHB 205-14EHB 205-15EHB 205-16EHB	SSUCFL205ESB 205-14ESB 205-15ESB 205-16ESB	7/8 15/16 1	25	130	99	16	13	28	12.5	68	35.8	34.1	14.3	M10	0.69
SSUCFL206EHB 206-17EHB 206-18EHB 206-19EHB 206-20EHB	SSUCFL206ESB 206-17ESB 206-18ESB 206-19ESB 206-20ESB	1-1/16 1-1/8 1-3/16 1-1/4	30	148	117	18	13	31	12.5	79	40.2	38.1	15.9	M10	0.99
SSUCFL207EHB 207-20EHB 207-21EHB 207-22EHB 207-23EHB	SSUCFL207ESB 207-20ESB 207-21ESB 207-22ESB 207-23ESB	1-1/4 1-5/16 1-3/8 1-7/16	35	161	130	19	14.3	34	14	90	44.4	42.9	17.5	M12	1.37
SSUCFL208EHB 208-24EHB 208-25EHB	SSUCFL208ESB 208-24ESB 208-25ESB	1-1/2 1-9/16	40	171	144	21	14.3	36	14	100	51.2	49.2	19	M12	1.65
SSUCFL209EHB 209-26EHB 209-27EHB 209-28EHB	SSUCFL209ESB 209-26ESB 209-27ESB 209-28ESB	1-5/8 1-11/16 1-3/4	45	179	148	22	15	38	16	108	52.2	49.2	19	M14	2.36
SSUCFL210EHB 210-30EHB 210-31EHB 210-32EHB	SSUCFL210ESB 210-30ESB 210-31ESB 210-32ESB	1-7/8 1-15/16 2	50	195	157	22	15	40	16	115	54.6	51.6	19	M14	2.51
SSUCFL211EHB 211-32EHB 211-34EHB 211-35EHB	SSUCFL211ESB 211-32ESB 211-34ESB 211-35ESB	2 2-1/8 2-3/16	55	224	184	25	18	43	19	130	58.4	55.6	22.2	M16	3.61
SSUCFL212EHB 212-36EHB 212-38EHB 212-39EHB	SSUCFL212ESB 212-36ESB 212-38ESB 212-39ESB	2-1/4 2-3/8 2-7/16	60	250	202	29	18	48	23	140	68.7	65.1	25.4	M16	4.19

Notes: 1.Upon request,available with plastic close cap(CC) or open cap(OC) at one end. Ordering example SSUCFL204-12ESB CC.
2.Back seal is available when mounted with narrow inner ring SSB/SSA inserts.
3.Lubricated with food grade grease.