

LDK[®] 3-Bolt Flange Units

SBFCT/SAFCT Light duty, Ductile iron housing, Setscrew/Eccentric locking



SBFCT200



SAFCT200

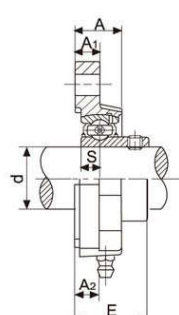
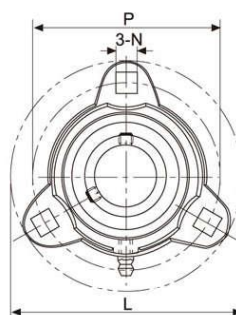

•SBFCT200•

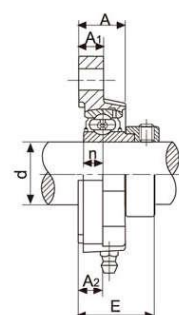

•SAFCT200•

SBFCT200 Series

Unit No.	Shaft Dia		Dimensions (mm)								Bolt Size		Bearing NO	Housing NO.	Weight (kg)
	d		L	P	A ₁	A	A ₂	N	S	E					
	(in)	(mm)													
SBFCT201		12													
201-8	1/2	12													
202		15	81	63.5	10.7	19.1	10.7	7.1	6	26.7	M6	1/4	SB201	FCT203	0.21
202-10	5/8	15											201-8		
203		17											202-10		
203-11	11/16	17											203		
													203-11		
SBFCT204-12	3/4												SB204-12	FCT204	0.32
204		20	90.5	71.4	11.1	19.8	11.1	8.7	7	29.1	M8	5/16	204		
SBFCT205-14	7/8												SB205-14	FCT205	0.36
205-15	15/16												205-15		
205		25	95.2	76.2	10.3	19.8	10.3	8.7	7.5	29.8	M8	5/16	205		
205-16	1	25											205-16		
SBFCT206-18	1-1/8												SB206-18	FCT206	0.57
206		30	113	90.5	12	22	12	10.3	8	34	M10	3/8	206		
206-19	1-3/16	30											206-19		
206-20	1-1/4	30											206-20		
SBFCT207-20	1-1/4												SB207-20	FCT207	0.71
207-21	1-5/16												207-21		
207-22	1-3/8	35	122.5	100	12.7	23.8	12.7	10.3	8.5	36.2	M10	3/8	207-22		
207													207		
207-23	1-7/16												207-23		

SAFCT200 Series

Unit No.	Shaft Dia		Dimensions (mm)								Bolt Size		Bearing NO	Housing NO.	Weight (kg)
	d		L	P	A ₁	A	A ₂	S	n	E					
	(in)	(mm)													
SAFCT201		12													
201-8	1/2	12													
202		15	81	63.5	10.7	19.1	10.7	7.1	6.5	32.8	M6	1/4	SA201	FCT203	0.26
202-10	5/8	15											201-8		
203		17											202-10		
203-11	11/16	17											203		
													203-11		
SAFCT204-12	3/4												SA204-12	FCT204	0.34
204		20	90.5	71.4	11.1	19.8	11.1	8.7	7.5	34.5	M8	5/16	204		
SAFCT205-14	7/8												SA205-14	FCT205	0.39
205-15	15/16												205-15		
205		25	95.2	76.2	10.3	19.8	10.3	8.7	7.5	33.7	M8	5/16	205		
205-16	1	25											205-16		
SAFCT206-18	1-1/8												SA206-18	FCT206	0.61
206		30	113	90.5	12	22	12	10.3	9	38.7	M10	3/8	206		
206-19	1-3/16	30											206-19		
206-20	1-1/4	30											206-20		
SAFCT207-20	1-1/4												SA207-20	FCT207	0.82
207-21	1-5/16												207-21		
207-22	1-3/8	35	122.5	100	12.7	23.8	12.7	10.3	9.5	42.1	M10	3/8	207-22		
207													207		
207-23	1-7/16												207-23		

Note: Cast iron housing is also available, Please check with LDK sales.