

LDK[®] 2-Bolt Flange Units

SBLF/SALF Light duty, Setscrew/Eccentric locking



SBLF200



SALF200

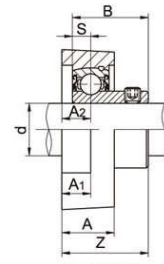
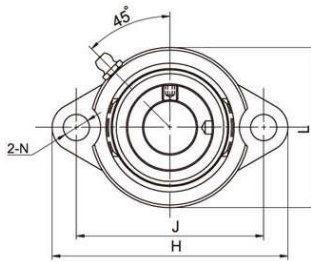

SBLF200

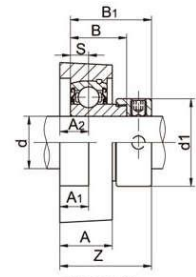

SALF200

SBLF200 Series

Unit No.	Shaft Dia		Dimensions(mm)										Bolt Size (mm)	Weight (kg)
	d		H	J	A ₂	A ₁	A	N	L	B	S	Z		
	(in)	(mm)												
SBLF201 201-8	1/2	12	81	63.5	9.5	9.5	18.0	8	56	22	6.0	25.5	M6	0.27
SBLF202 202-9 202-10	9/16 5/8	15	81	63.5	9.5	9.5	18.0	8	56	22	6.0	25.5	M6	0.25
SBLF203 203-11	11/16	17	81	63.5	9.5	9.5	18.0	8	56	22	6.0	25.5	M6	0.25
SBLF204 204-12	3/4	20	90	71.5	11.0	11.0	20.0	10	61	25	7.0	29.0	M8	0.33
SBLF205 205-14 205-15 205-16	7/8 15/16 1	25	95	76.0	11.0	11.0	20.0	10	64	27	7.5	30.5	M8	0.38
SBLF206 206-17 206-18 206-19 206-20	1-11/16 1-1/8 1-3/16 1-1/4	30	113	90.5	12.0	12.0	22.5	12	76	30	8.0	34.0	M10	0.56
SBLF207 207-20 207-21 207-22 207-23	1-1/4 1-5/16 1-3/8 1-7/16	35	122	100	13	13.0	24	12	89	32	8.5	36.5	M10	0.8
SBLF208 208-24 208-25	1-1/2 1-9/16	40	150	119	13.5	13.0	25	14	106	34	9	38.5	M12	1.48

SALF200 Series

Unit No.	Shaft Dia		Dimensions(mm)												Bolt Size (mm)	Weight (kg)
	d		H	J	A ₂	A ₁	A	N	L	B ₁	B	S	Z	d ₁		
	(in)	(mm)														
SALF201 201-8	1/2	12	81	63.5	9.5	9.5	18.0	8	56	28.6	19.1	6.0	32.1	28.6	M6	0.28
SALF202 202-9 202-10	9/16 5/8	15	81	63.5	9.5	9.5	18.0	8	56	28.6	19.1	6.0	32.1	28.6	M6	0.28
SALF203 203-11	11/16	17	81	63.5	9.5	9.5	18.0	8	56	28.6	19.1	6.0	32.1	28.6	M6	0.28
SALF204 204-12	3/4	20	90	71.5	11.0	11.0	20.0	10	61	31	21.5	7.0	35	33.3	M8	0.33
SALF205 205-14 205-15 205-16	7/8 15/16 1	25	95	76.0	11.0	11.0	20.0	10	64	31.5	22	7.5	35	38.1	M8	0.42
SALF206 206-17 206-18 206-19 206-20	1-11/16 1-1/8 1-3/16 1-1/4	30	113	90.5	12.0	12.0	22.5	12	76	35.7	23.8	8.0	39.7	44.5	M10	0.6
SALF207 207-20 207-21 207-22 207-23	1-1/4 1-5/16 1-3/8 1-7/16	35	122	100	13.0	13.0	24.0	12	89	38.9	25.4	8.5	43.4	55.6	M10	0.85
SALF208 208-24 208-25	1-1/2 1-9/16	40	150	119	13.5	13	25	14	106	43.7	30.2	9	48.2	60.3	M12	1.48