

LDK[®] 2-Bolt Flange Units

NAFL Standard duty,Wider inner ring bearing, Eccentric locking

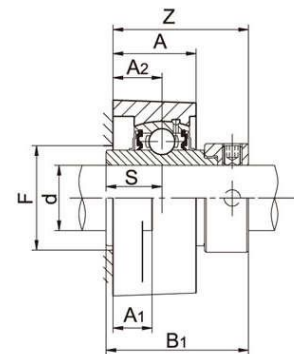
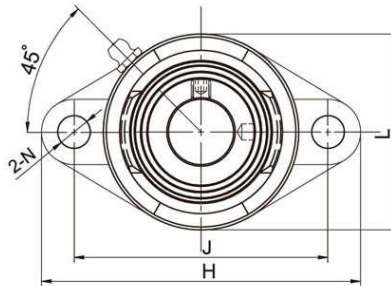

Unit No.	Shaft Dia		Dimensions (mm)											Bolt Size (mm)	Weight (kg)
	d		H	J	A ₂	A ₁	A	N	L	B ₁	S	Z	F		
	(in)	(mm)													
NAFL201S 201-8S 202S 202-10S 203S 203-11S	1/2 5/8 11/16	12 15 17	97	76.5	15	11	25.5	11.5	55	37.3	13.9	38.2	--	M10	0.48
NAFL201 201-8 202 202-10 203 203-11 204 204-12	1/2 5/8 11/16 3/4	12 15 17 20	113	90	15	11	25.5	12	60	43.7	17.1	41.6	32	M10	0.73
NAFL205 205-14 205-15 205-16	7/8 15/16 1	25	130	99	16	13	27	16	68	44.4	17.5	42.9	36	M14	0.80
NAFL206 206-17 206-18 206-19 206-20	1-1/16 1-1/8 1-3/16 1-1/4	30	148	117	18	13	31	16	80	48.4	18.3	48.1	42	M14	1.2
NAFL207 207-20 207-21 207-22 207-23	1-1/4 1-5/16 1-3/8 1-7/16	35	160	130	19	15	34	16	90	51.1	18.8	51.3	50	M14	1.6
NAFL208 208-24 208-25	1-1/2 1-9/16	40	175	144	21	15	36	16	100	56.3	21.4	55.9	55	M14	1.9
NAFL209 209-26 209-27 209-28	1-5/8 1-11/16 1-3/4	45	188	148	22	16	38	19	108	56.3	21.4	56.9	60	M16	2.30
NAFL210 210-30 210-31	1-7/8 1-15/16	50	197	157	22	16	40	19	115	62.7	24.6	60.1	64	M16	2.60
NAFL211 211-32 211-34 211-35	2 2-1/8 2-3/16	55	224	184	25	18	43	19	125	71.4	27.8	68.6	71	M16	3.80
NAFL212 212-36 212-38 212-39	2-1/4 2-3/8 2-7/16	60	250	202	29	18	48	23	140	77.8	31	75.8	78	M20	4.80
NAFL213 213-40	2-1/2	65	258	210	30	22	50	23	153	85.7	34.1	81.6	85	M20	6
NAFL214 214-44	2-3/4	70	265	216	31	22	54	23	160	85.7	34.1	82.6	91	M20	6.3
NAFL215 215-48	3	75	275	225	34	22	56	23	165	92.1	37.3	88.8	96	M20	7.2

Notes: Bearing housing solid base optional, add suffix SB as designation.